

WEST SUSSEX COUNTY COUNCIL
((MID SUSSEX DISTRICT)(PARKING PLACES & TRAFFIC REGULATION)
(CONSOLIDATION NO.2) ORDER 2006)
(BURGESS HILL: LEYLANDS ROAD, STATION ROAD AND ADJOINING ROADS AMENDMENT)
ORDER 2023

BURGESS HILL: LOCATION OF WAITING RESTRICTIONS

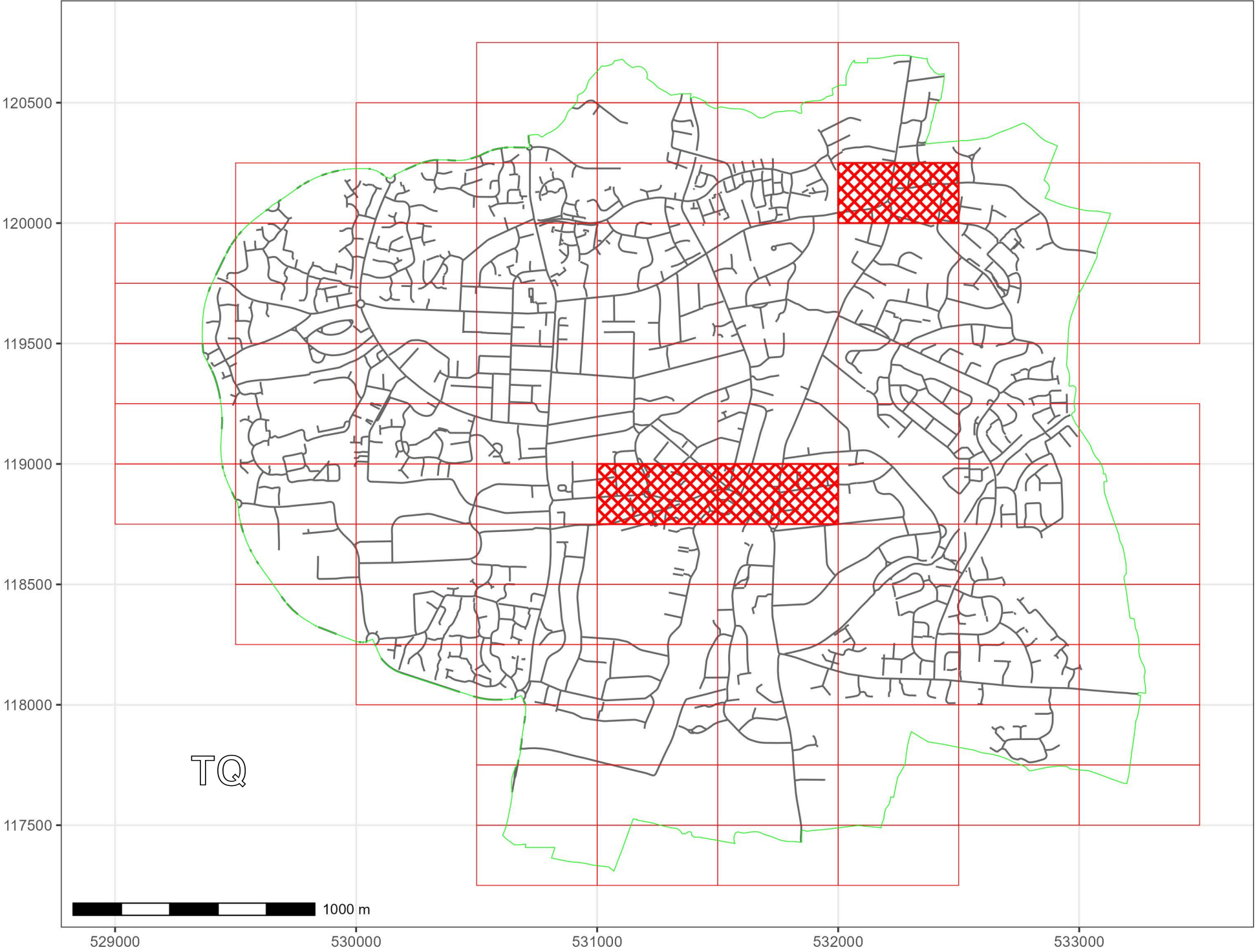

KEY:

OS.TILE GRID

PARKING TILE GRID

West Sussex County Council
Highways & Transport
The Grange
Tower Street
Chichester
West Sussex
PO19 1RH

WEST SUSSEX COUNTY COUNCIL
((MID SUSSEX DISTRICT)(PARKING PLACES & TRAFFIC
REGULATION)(CONSOLIDATION NO.2) ORDER 2006)
(BURGESS HILL: LEYLANDS ROAD, STATION ROAD AND
ADJOINING ROADS AMENDMENT) ORDER 2023



LOCATION OF WAITING RESTRICTIONS



Key for Waiting Restrictions

All areas over which the provision of the orders apply are defined by the shaded areas as shown on the following plans plus a contiguous area not indicated on the plans of verge and/or footway between the carriageway edge and the highway boundary. The plans in this schedule are based upon grid references of the Ordnance Survey National Grid defined by the OSGB 36 triangulation.

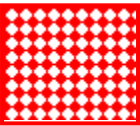

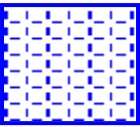
Prohibition of Waiting

100		z_circle	No waiting, loading and unloading at any time
101		check	No waiting at any time
107		pat020	No waiting 8.00am-6.00pm Mon-Sat

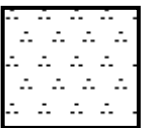

Free Limited Waiting

714		pat064	Waiting limited to 1hr No return within 1hr 8.30am-6.00pm Mon-Sat
716		shd62	Waiting limited to 1hr No return within 1hr 8.00am-6.00pm Mon-Sat
730		usgs505	Waiting limited to 30mins No return within 1hr 8.00am-6.00pm Mon-Sat
764		shd132	Waiting limited to 30mins No return within 1hr 8.00am-6.00pm any day

Specified Vehicles

871		historic	No waiting 8.00am-6.00pm Mon-Sat except taxis
874		herring3	Disabled persons vehicles 9.00am-5.30pm Mon-Sat

Clearways

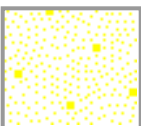
1106		rice1	School Keep Clear No stopping 8.00am-6.00pm Mon-Fri
1110		usgs677	School Keep Clear No stopping 8.00am-5.00pm Mon-Fri
1113		pat055	Bus stop clearway No stopping except buses 8.00am-6.00pm Mon-Sat

WEST SUSSEX COUNTY COUNCIL
((MID SUSSEX DISTRICT) (PARKING PLACES & TRAFFIC REGULATION)
(CONSOLIDATION NO.2) ORDER 2006)

(BURGESS HILL: LEYLANDS ROAD, STATION ROAD AND ADJOINING ROADS
AMENDMENT) ORDER 2023

West Sussex County Council in exercise of their powers under Sections 1 (a) 2 (1) and (2), 4 (2), 45. 46. 49 and 53 and Part IV of Schedule 9 of the Road Traffic Regulation Act 1984 ("the Act") as amended and of all other enabling powers and after consultation with the Chief Officer of Police in accordance with Part III of Schedule 9 to the Act hereby make the following Order:-

1. The Order shall come into operation on the Eleventh day of December 2023 and may be cited as "West Sussex County Council) ((Mid Sussex District) (Parking Places & Traffic Regulation) (Consolidation No.2) Order 2006) (Burgess Hill: Leylands Road, Station Road and Adjoining Roads Amendment) Order 2023".
2. The "West Sussex County Council ((Mid Sussex District) (Parking Places & Traffic Regulation) (Consolidation No.2) Order 2006" is hereby amended by the replacement of the plans specified in the First Schedule to this Order, with the plans specified in the Second Schedule, attached hereto.

FIRST SCHEDULE
Plans to be Replaced

TQ3118NEN (Issue Number 5)
TQ3118NWN (Issue Number 6)
TQ3220SWS (Issue Number 5)

SECOND SCHEDULE
Replacement Plans

TQ3118NEN (Issue Number 6)
TQ3118NWN (Issue Number 7)
TQ3220SWS (Issue Number 6)

For and on behalf of WEST SUSSEX COUNTY COUNCIL

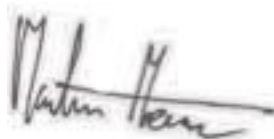

Authorised Signatory:

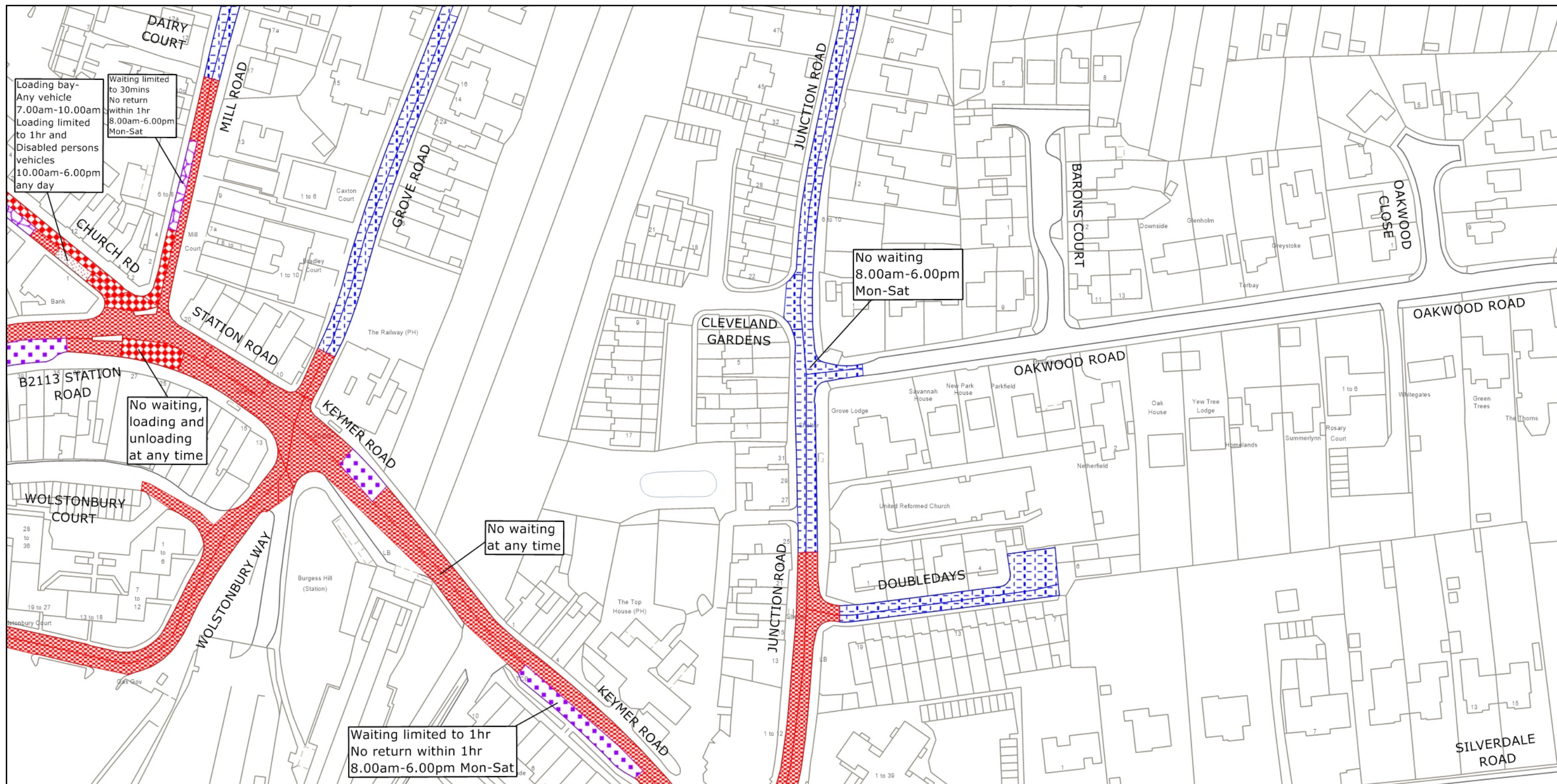

NAME: Martin Moore

DATE MADE: Seventh day of December 2023



	<p>West Sussex County Council Highways & Transport The Grange Tower Street Chichester West Sussex PO19 1RH</p>	<p>MID SUSSEX DISTRICT: BURGESS HILL</p> <p>WAITING RESTRICTIONS</p>	<p>TILE REF NO: TQ3118NEN</p> <p>SHEET ISSUE NO 6</p> <p>SHEET ACTIVE FROM - 11.12.2023</p>	<p>N</p>  <p>SCALE: 1:1250 at A3 size</p>
<p><small>© Crown copyright and database rights 2023 OS AC0000849983. You are permitted to use this data solely to enable you to respond to, or interact with, the organisation that provided you with the data. You are not permitted to copy, sub-license, distribute or sell any of this data to third parties in any form.</small></p>				

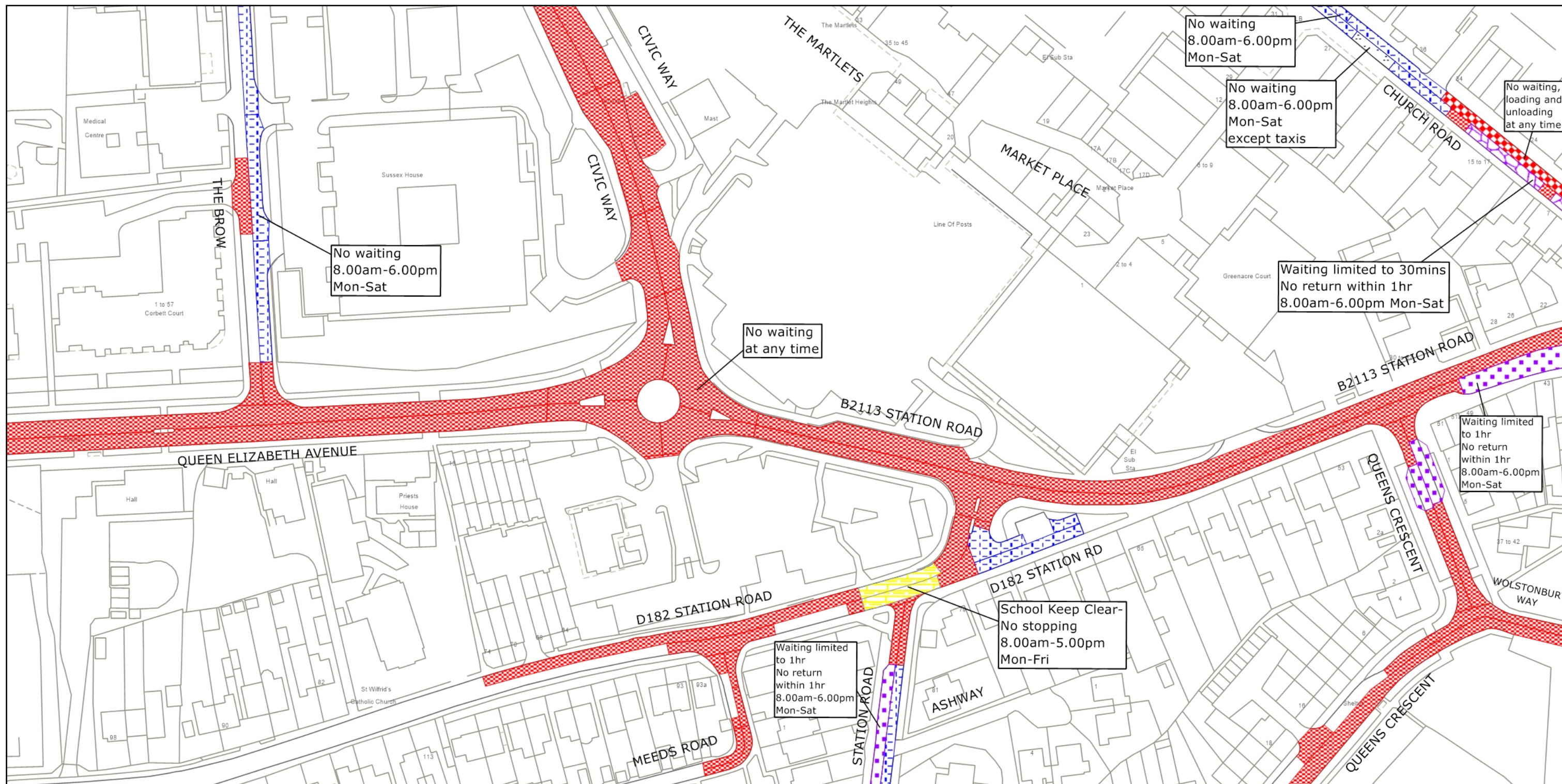

West Sussex County Council
Highways & Transport
The Grange
Tower Street
Chichester
West Sussex
PO19 1RH

MID SUSSEX DISTRICT: BURGESS HILL

WAITING RESTRICTIONS

© Crown copyright and database rights 2023 OS AC0000849983. You are permitted to use this data solely to enable you to respond to, or interact with, the organisation that provided you with the data. You are not permitted to copy, sub-license, distribute or sell any of this data to third parties in any form.



TILE REF NO:
TQ3118NWN

SHEET ISSUE NO 7
SHEET ACTIVE FROM - 11.12.2023

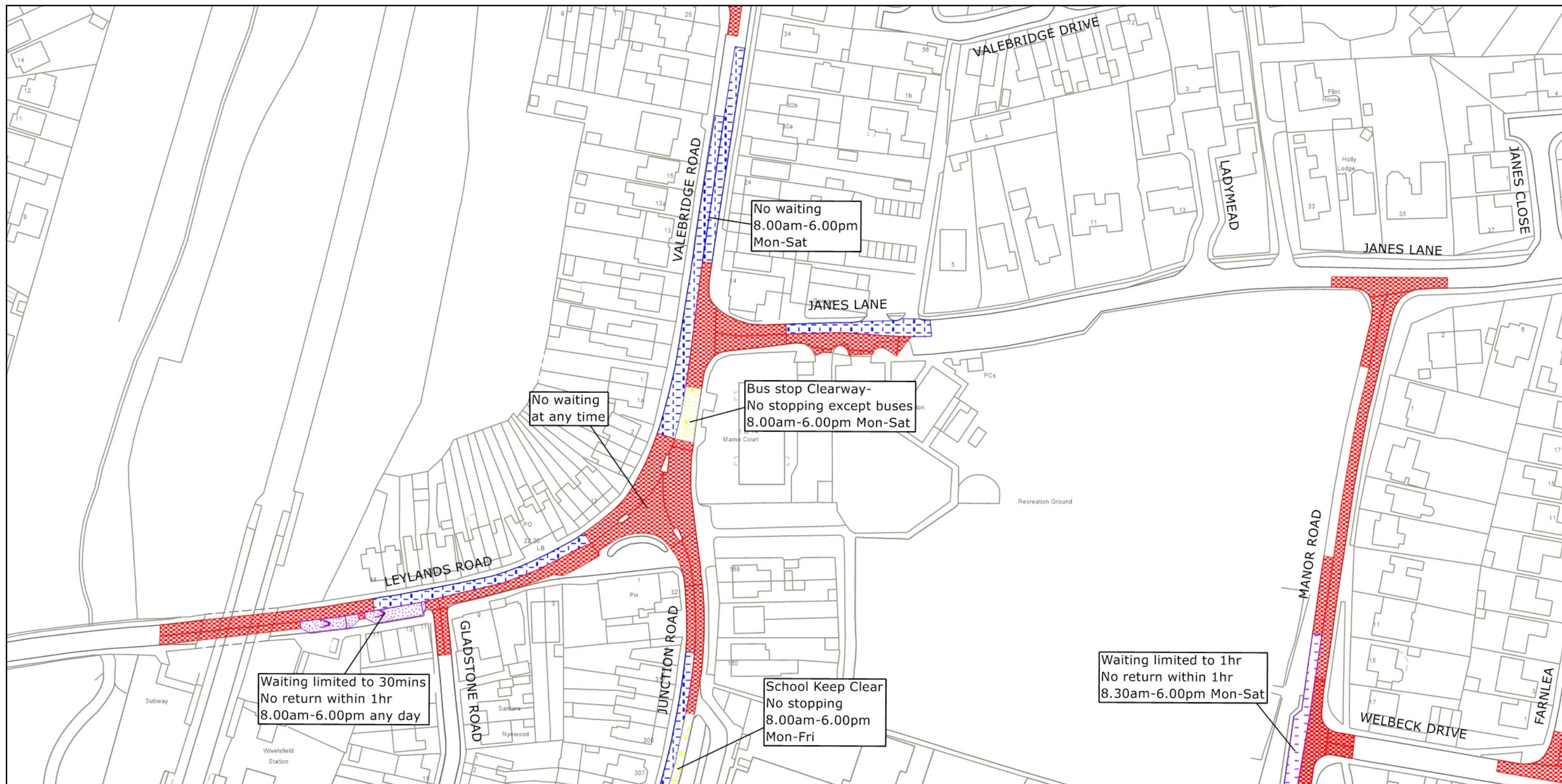

SCALE:
1:1250
at A3 size



 <p>west sussex county council</p>	<p>West Sussex County Council Highways & Transport The Grange Tower Street Chichester West Sussex PO19 1RH</p>	<p>MID SUSSEX DISTRICT: BURGESS HILL</p> <p>WAITING RESTRICTIONS</p>	<p>TILE REF NO: TQ3220SWS</p> <p>SHEET ISSUE NO 6</p> <p>SHEET ACTIVE FROM - 11.12.2023</p>	<p>N</p>  <p>SCALE: 1:1250 at A3 size</p>
<p><small>© Crown copyright and database rights 2023 OS AC0000849983. You are permitted to use this data solely to enable you to respond to, or interact with, the organisation that provided you with the data. You are not permitted to copy, sub-license, distribute or sell any of this data to third parties in any form.</small></p>				